

DEPENDABLE. TOUGH. THAT'S FETERL. MODEL 8,000 CRANE WITH 11' HEAVY DUTY CRANE BODY.

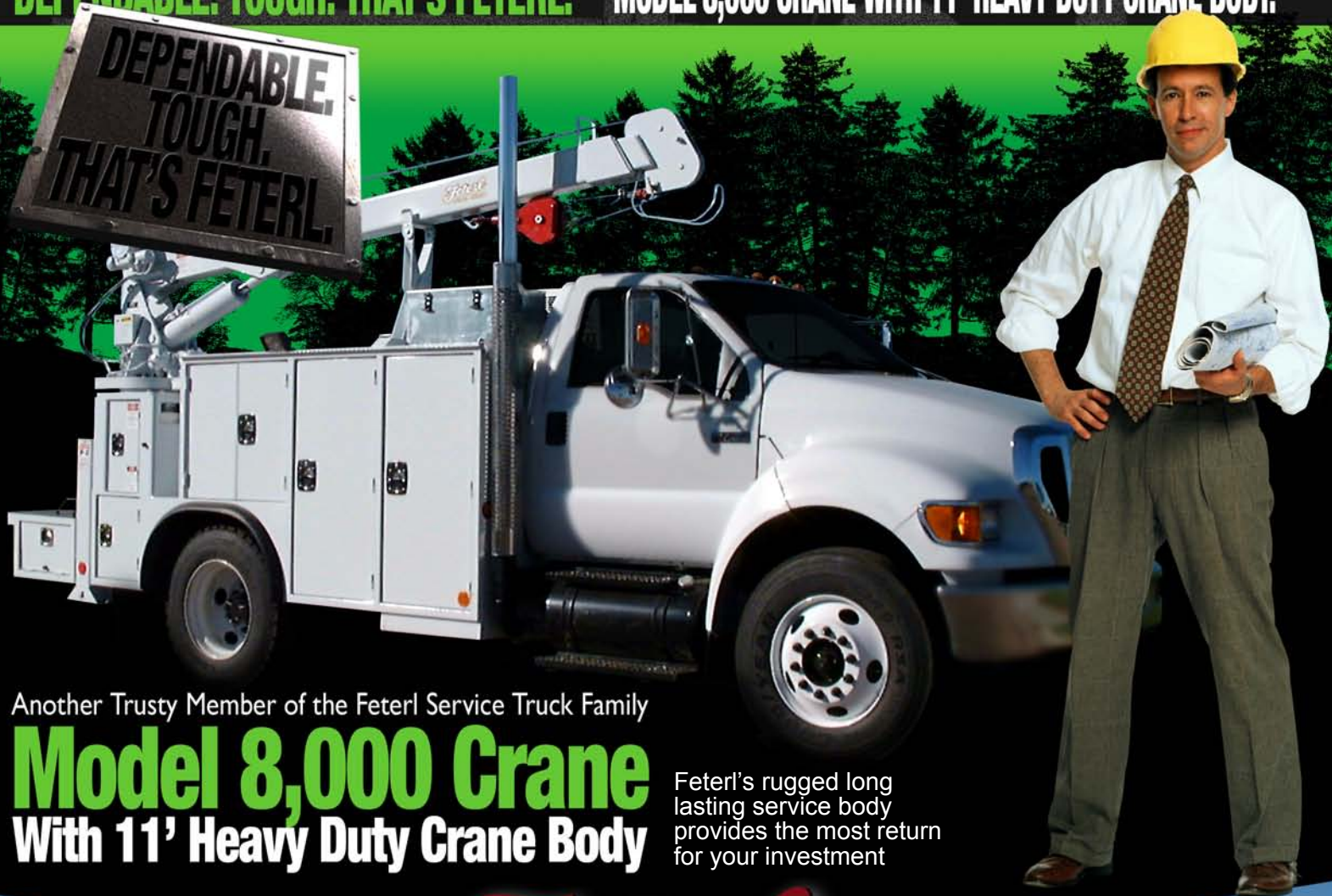

Another Trusty Member of the Feterl Service Truck Family

Model 8,000 Crane With 11' Heavy Duty Crane Body

Feterl's rugged long lasting service body provides the most return for your investment

Feterl



The Model 8000 series commercial bodies are designed for a 2 ton truck with a clear 84" CA, 21,000 GVW-33,000 GVW. Our heavy duty crane body compartments are 24" D x 56" H all built of 10 ga. steel with 10 ga. reinforced doors and stainless steel hinges. Compartments are pressurized and have automotive weather stripping, plus the "Gang Lock"™ is featured on all models. A 1/4" crane tower is 100% welded to the over-all substructure. A full 50" deck area has 1/8" tread plate throughout.

This body is available with the 6,000, 8,000, or 10,000 lb. cranes.

The Feterl G2-8H 8,000 lb. Crane is designed to meet ASME B30.5 standards, and has been certified to SAE J1063 Test Specifications.

Feterl

Manufacturing Corp.

MODEL 8,000 CRANE WITH 11' HEAVY DUTY CRANE BODY. **DEPENDABLE. TOUGH. THAT'S FETERL.**



Model G2-8H Crane Specifications

G2-8H 8,000 lb. Crane Designed to Meet ASME B30.5 Crane Specifications.

G2-8H 8,000 lb. Crane Design Tested and Certified to Meet the SAE J1063 Crane Testing Specifications.

Weight: 2350 lb. (1065 kg)
 Storage Dimensions: 24" W, 46" H, 14'10" L (61 cm W x 117 cm H x 452 cm L)
 Base Plate Dimensions: 24" x 24" (61 cm x 61 cm)
 Horizontal Reach: 13-1/2 ft. (4.11 m) to 22-1/2 ft. (6.86 m) with 9 ft. (2.74 m) hydraulic extension and 3-1/2 ft. (1.1 m) manual extension
 Vertical Reach: -1 to 25 ft. (-0.3 m to 7.6 m)
 Cable Reach At Max Extension (from tip of boom):
 Single Line: 66 ft. (20 m)
 Double Line: 30 ft. (9.1 m)
 Boom Elevation: -8° to 80°
 Rotation: 370°
 Cable: 95 ft. (29 m) 3/8" (.95 cm) IWRC cable, 4000 lb. (1813 kg) single line pull.
 Winch speed: 16-21 ft./min. (4.9-6.4 m/min) single line pull, 8 -10-1/2 ft./min (2.4-3.2 m/min) double line pull.

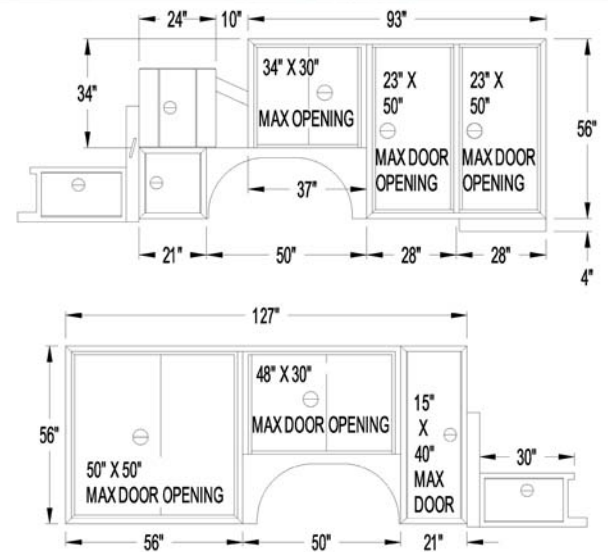

Quality Standard Equipment

- | | |
|----------------------------------|--------------------------------------|
| Complete Crane Manual | 10 Gauge Doors |
| Fire Extinguisher | Special Automotive Weather Stripping |
| Warning Triangles, Side Markers | Seven Adjustable Shelves |
| Undercoating | Full Length Drip Rails |
| Hydraulic Outriggers | 50" Tread Plate Deck Area |
| 1/4" Crane Towers | Flush Mounted Lights |
| HD Removable Tail Gate | Mud Flaps |
| Hydraulic Oil Reservoir | Sleeved Substructure |
| Custom Stainless Steel Hinges | Wiring in Conduit/Loom |
| Crane Saddle | Complete Filter System |
| No Wheel Wells | In-Deck Tie Downs |
| Power Extensions on Cranes | 60" Oxy/Acty Compartment |
| "The Gang Lock" TM | Power In & Out Outriggers |
| Crane Overload Protection System | Wired/Wireless Crane Controls |
| 10 Gauge Compartments | |
| Pressurized Compartments | |

Quality Optional Equipment

- | | |
|--|--|
| PTO Pump | Extra Shelving |
| 18" or 30" Heavy Duty Workbench | Compartment Lighting |
| Hydraulic Oil Cooler Thermostat Controlled | Extra Compartments |
| Heavy Duty Step Bumper | Hydraulic Driven Air Compressor |
| Added Leaf Springs/Spacers | Engine Driven Air Compressors (G or D) |
| Drawers w/ Ball Bearing Slides | Welder/Generators (Gas, Diesel or Hydraulic) |
| Light Packages | Evac. Systems |
| Welder Decks | Bolt Bins |
| Mini Lube Systems | Extra ASME Air Tanks |
| Electrical Plug-Ins | Side Mounted Tie Downs |
| Top Covers/Fold Back or Other | Rear Step w/ Hand Rail |
| Vise & Grinder Mounts | Parts Washer |

